

REFRIGERATOR MERCHANDISERS

Model	Product ID	Size
KGD48R	919610	(2) Doors, 48 cu ft

STANDARD FEATURES

- Triple pane locking glass doors w/ heat reflecting film
- Very bright LED lighting
- (4) Epoxy coated shelves per section
- Adjustable heavy duty coated shelves
- High density insulation
- Solid state temperature control w/ digital display
- Removable door gaskets
- Whisper quiet, high efficient compressor
- Visually appealing to compliment products stored
- Economically designed door handle
- Bottom mount, slide out condenser

KGD48R

WARRANTY

Kintera Refrigeration equipment is warranted to be free from defects in material and workmanship under normal use and service for a period of 2 years for parts and labor. The compressor carries an additional 3 year warranty for the part only.

Items	Description	Items	Description
External top & side	Enamel coated steel	Temperature control	Solid state thermostat w/ digital display
Door	Glass - triple pane, tempered	Comply to standard	ETL
External back	Aluminum	Refrigerating system	Capillary tube
Cabinet internal	White aluminum	Refrigerant	R290
Internal floor	300 Series stainless steel	Temp. range in box	33°F to 41°F
Insulation	Polyurethane (CFC free)	Evaporator/condenser	Aluminum + copper
Shelves	Heavy duty, Epoxy coating	Condensing unit	Bottom
Lighting	LED	Door lock	Standard

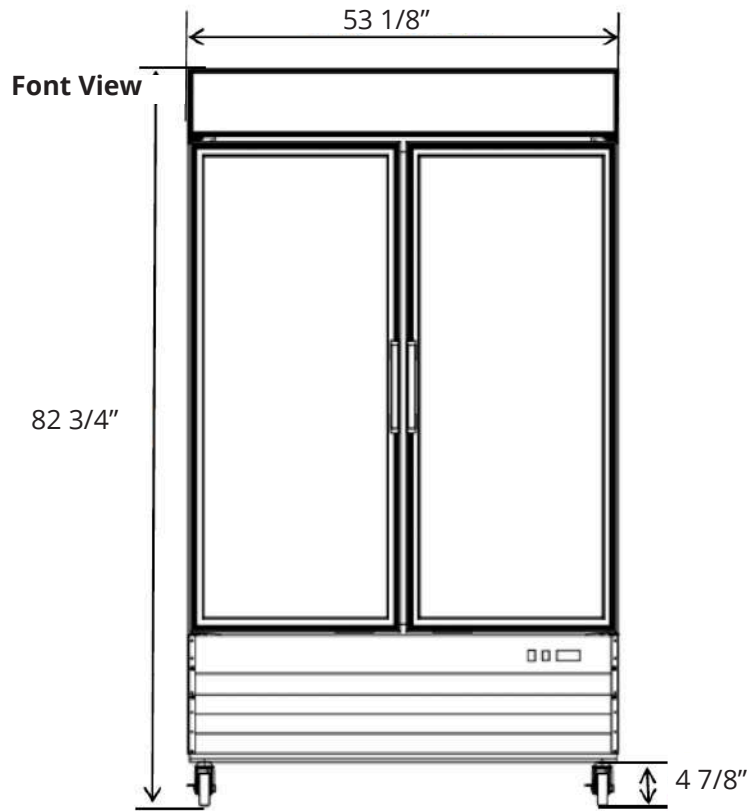

Side View

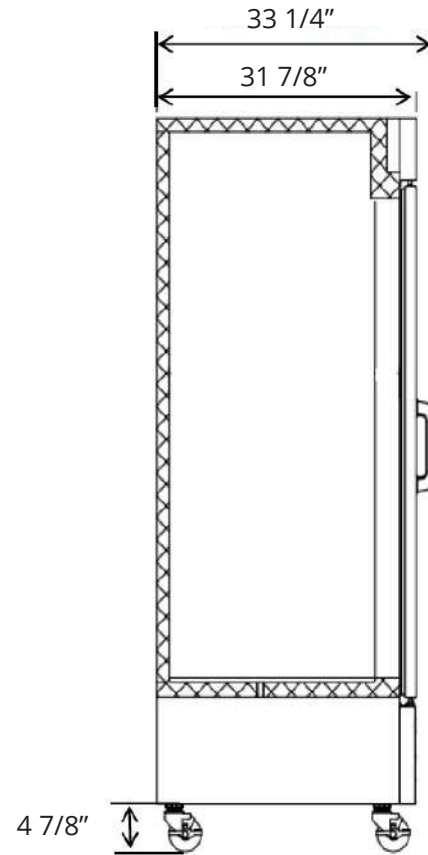

Top View

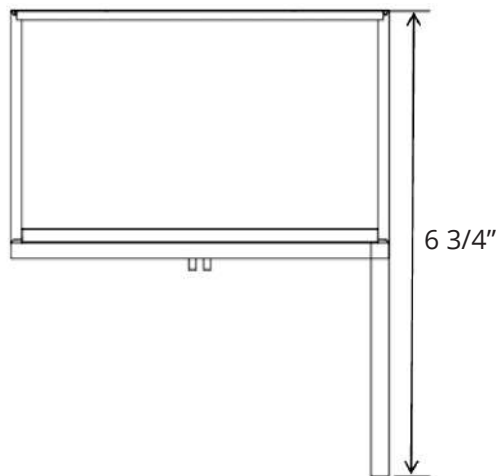

Model	Product ID	# of Doors	Storage CAP (cu ft)	Shelves	Shelves Sizes (in)	Cabinet Dimensions			HP	Voltage /Hz /ph	Amp	NEMA Plug	Cord Length (ft)	Crated Weight (lbs)
						W	D	H						
KGD48R	919610	2	48	8	22 x 27	53 1/8"	33 1/4"	82 3/4"	1/4	115/60/1	4.5	 5-15P	10	540

* Plug Type Varies by Country.